

REV. NO.	DESCRIPTION	DATE

DESIGN DATA

CONCRETE CLASS AA
 REINFORCING STEEL (GRADE 60) $f'c = 4$ K.S.I.
 $fy = 60$ K.S.I.

LOADING:
 HL-93 OR OKLAHOMA OVERLOAD TRUCK

DESIGN:
 AASHTO LRFD BRIDGE DESIGN SPECIFICATIONS, 4TH EDITION, WITH 2008 INTERIMS

LFD OPERATING RATING: HS 119.4

INDEX OF SHEETS

4	SUMMARY OF BRIDGE PAY QUANTITIES AND GENERAL NOTES
14	GENERAL PLAN AND ELEVATION
15	R.C.B. DETAILS
16	PLAN AND ELEVATION - RETAINING WALLS A & B
17	FOUNDATION REPORT
18-20	RETAINING WALL DETAILS

STANDARDS

SBI-4-2	RCB-E2-H9-30-2-01E
RCB-C2-14(2-10)-01E	RCB-E2-H9-30-3-01E
RCB-E2-H9-30-1-01E	RCB-CW2-D6-30-01E

HYDRAULIC DATA

TOTAL DRAINAGE AREA	= 7.02 SQ. MILES
CONTROLLED DRAINAGE AREA	= 2.44 SQ. MILES
EFFECTIVE DRAINAGE AREA	= 4.58 SQ. MILES
Q2	= 301 C.F.S.
V2	= 2.34 F.P.S.
Q2 COMPUTED HIGHWATER ELEVATION	= 1598.71 FT.
Q5	= 697 C.F.S.
V5	= 3.80 F.P.S.
Q5 COMPUTED HIGHWATER ELEVATION	= 1600.69 FT.
Q10	= 1110 C.F.S.
V10	= 5.52 F.P.S.
Q10 COMPUTED HIGHWATER ELEVATION	= 1601.80 FT.
Q25	= 1810 C.F.S.
V25	= 9.19 F.P.S.
Q25 COMPUTED HIGHWATER ELEVATION	= 1603.19 FT.
Q50	= 2410 C.F.S.
V50	= 10.10 F.P.S.
Q50 COMPUTED HIGHWATER ELEVATION	= 1605.09 FT.
Q100	= 3130 C.F.S.
V100	= 12.42 F.P.S.
Q100 COMPUTED HIGHWATER ELEVATION	= 1607.08 FT.
Q0T = Q455	= 5025 C.F.S.
V455	= 17.5 F.P.S.
Q455 COMPUTED HIGHWATER ELEVATION	= 1612.52 FT.

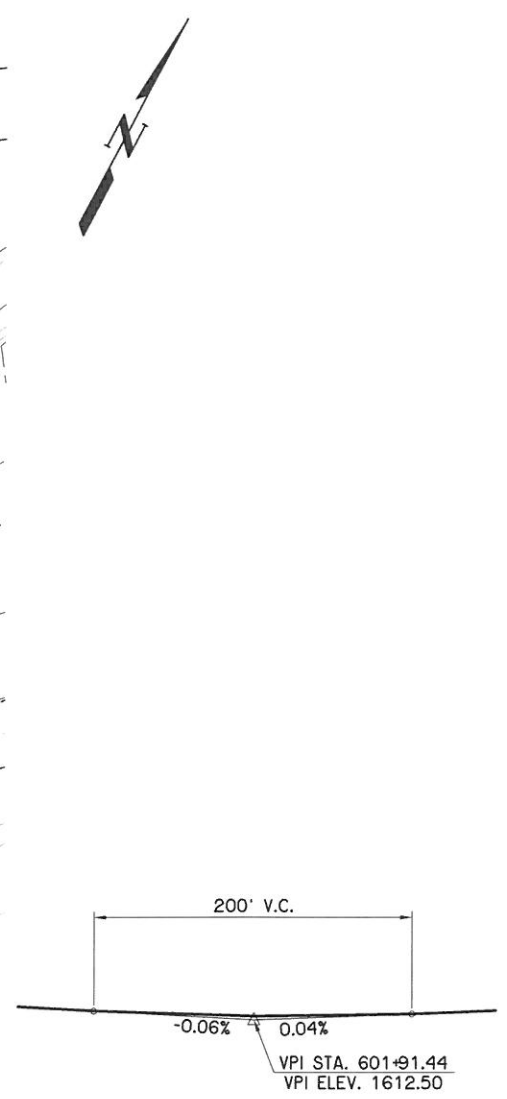
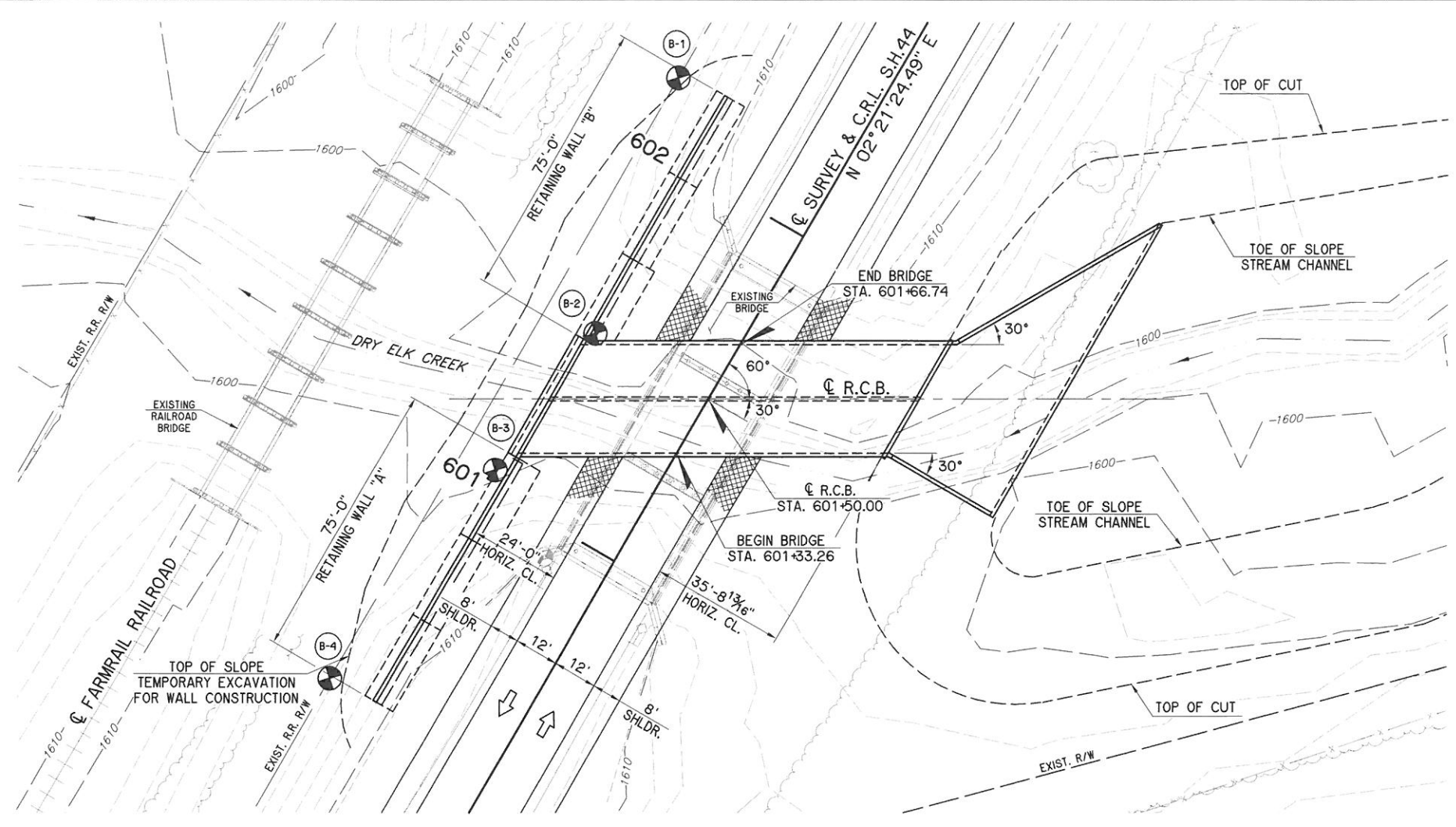

BM #3
 SET CUT "X" ON TOP OF CONC. WINGWALL
 STA. 600+91.60 17.00' LT. ELEV. = 1613.12

BM #4
 SET CUT "X" IN TOP OF CONC. FLUME
 STA. 608+66.80 51.3' RT. ELEV. = 1606.69

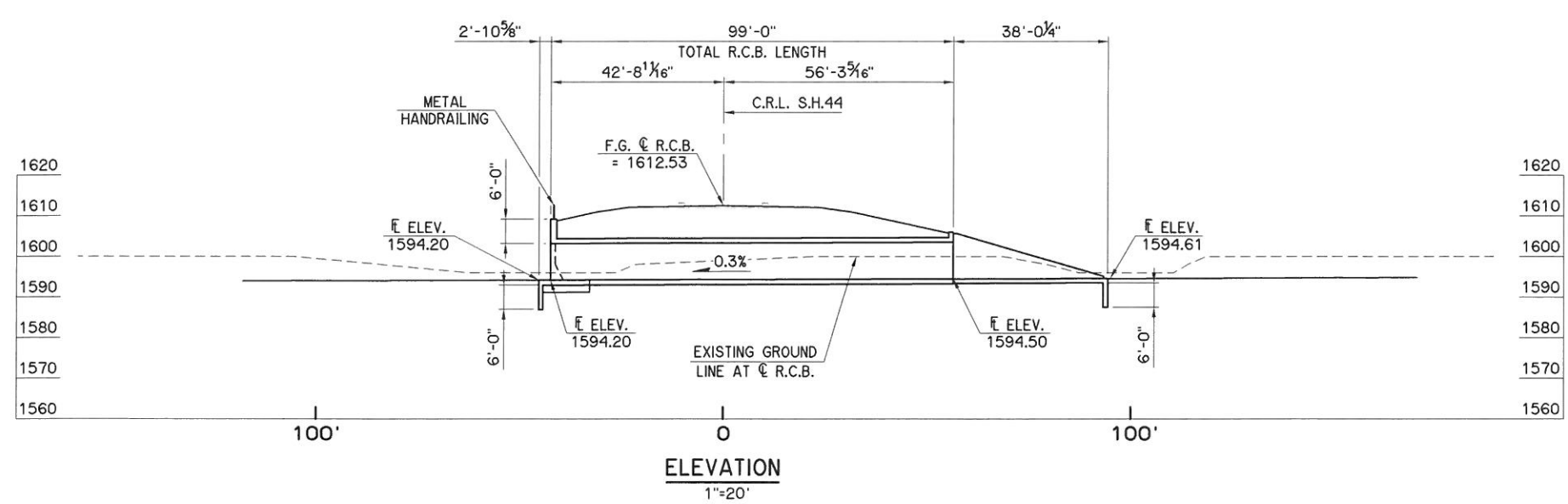

SUMMARY OF QUANTITIES		
ITEM	UNIT	TOTAL
UNCLASSIFIED EXCAVATION	C.Y.	1,810
STRUCTURAL EXCAVATION UNCLASSIFIED	C.Y.	230
HANDRAILING	L.F.	185.5
CLASS AA CONCRETE	C.Y.	518.1
RETAINING WALL	S.Y.	207.0
REINFORCING STEEL	LB.	87,870
PILES, FURNISHED (HP 10x42)	L.F.	1,650
PILES, DRIVEN (HP 10x42)	L.F.	1,650
PILE SPLICE, H-PILE (NON-BIDDABLE)	EA.	1
REMOVAL OF EXISTING BRIDGE STRUCTURE	L.SUM	1

S.H. 44 OVER DRY ELK CREEK WASHITA COUNTY
GENERAL PLAN AND ELEVATION
 2 - 14' x 9' x 99' R.C.B.
 @ STA. 601+50.00, 30° SKEW RT. FWD.

Design	AFW
Detail	DRB
Check	AFW

WHITE ENGINEERING ASSOCIATES
 STATE OF OKLAHOMA DEPARTMENT OF TRANSPORTATION
 JOB PIECE NO. 28774(04) SHEET NO. 14

I:\Active\1220\DWG\PE REVISED.dwg, 2/22/2016 11:28:37 AM, Deanne